

Tuff Torq K46 BN1

Spare parts
Ersatzteile
Pièces détachées
Reserve onderdelen
Repuestos
Reservdelar

ACTUAL PARTS
 MAY NOT APPEAR
 AS SHOWN

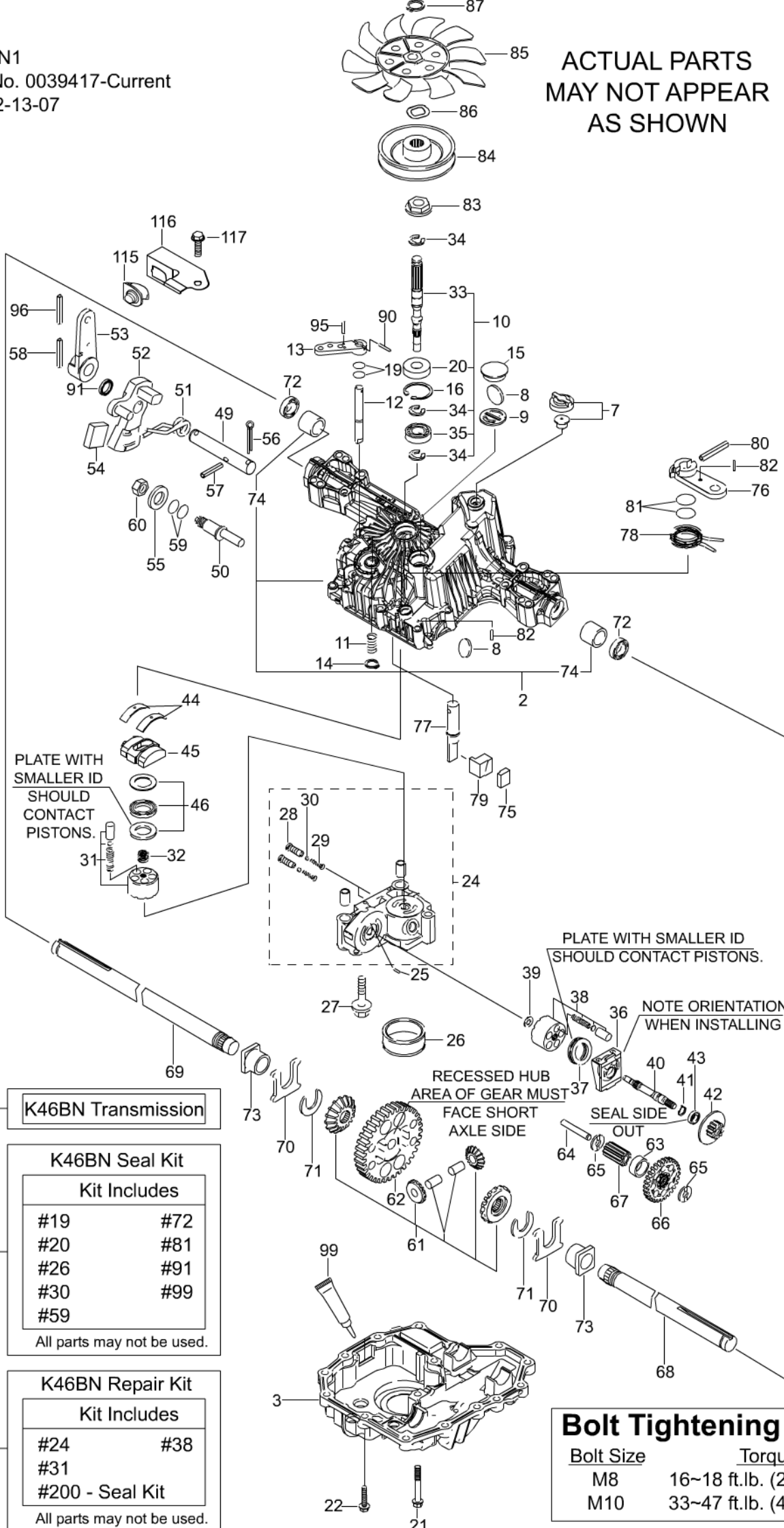

1 K46BN Transmission

200

K46BN Seal Kit

Kit Includes

#19	#72
#20	#81
#26	#91
#30	#99
#59	

All parts may not be used.

201

K46BN Repair Kit

Kit Includes

#24	#38
#31	
#200 - Seal Kit	

All parts may not be used.

Bolt Tightening Specs.

Bolt Size	Torque
M8	16~18 ft.lb. (21~24 N.m)
M10	33~47 ft.lb. (45~64 N.m)

K46BN1

K46BN 0039417-9999999 - (K46BN-HOP / 7A646084160 & 61)

KEY NO.	PART NO.	DESCRIPTION	TUFF TORQ PART NO	KEY NO.	PART NO.	DESCRIPTION	TUFF TORQ PART NO.
1	522 54 11-01	K46BN	7A646084161	56	502 45 24-01	COTTER PIN 1/8" * 3/4"	1A646029940
2	505 56 36-01	UPPER CASE KIT	1A646084421	57	502 46 18-01	SPRING PIN 6 * 36	22351060036
3	505 56 37-01	LOWER CASE	1A646084300	58	535 40 28-09	ROLL PIN 6 * 40	22351060040
7	505 56 38-01	VENT VALVE 15	19485924252	59	535 40 28-14	O-RING 1A P14	24311000140
8	505 56 39-01	MAGNET	19216324360	60	506 95 66-01	NUT 12	26776120002
9	502 45 20-01	MAGNET HOLDER	1A646029000	61	535 40 28-99	DIFF GEAR KIT	1A646031570
10	502 46 01-01	PUMP SHAFT/BEARING KIT	1A646099950	62	535 41 46-04	FINAL GEAR (54T)	1A646033520
11	502 46 01-01	SPRING 25	19215427281	63	535 41 46-05	FINAL PINION COLLAR	1A646033250
12	505 56 40-01	BYPASS SHAFT A	1A646029510	64	535 41 46-06	REDUCTION SHAFT	1A646088820
13	535 40 28-17	BYPASS LEVER	1A632029520	65	502 46 07-01	WASHER 12 * 32 * 3.2	19216833420
14	535 40 28-49	SNAP RING 10	19216829570	66	502 45 30-01	REDUCTION GEAR (38T)	1A646085240
15	535 40 28-32	SEALING CAP 30	1C655036300	67	502 45 27-01	FINAL PINION GEAR (10T)	1A646033531
16	535 40 28-50	SNAP RING C 35	22252000350	68	535 41 46-10	AXLE SHAFT, LEFT	1A646034111
19	535 40 28-15	O-RING 1A P10A	24311240100	69	535 41 46-11	AXLE SHAFT, RIGHT	1A646034121
20	502 46 23-01	SEAL TC 153507	24421153507	70	535 41 46-12	THRUST WASHER	19216334261
21	535 40 28-51	TAPPING SCREW 8 * 55	26476080552	71	535 41 46-13	RING 17	19216834270
22	535 40 28-28	TAPPING SCREW 8 * 30	26476080302	72	535 40 28-37	SEAL 19 * 32 * 8	19216334280
24	505 56 41-01	CENTER CASE K W/ 1.2 FILTER IDS KIT	1A646099070	73	535 41 46-14	BUSHING 19 * 25	19216834350
25	535 40 28-58	PIN 3 * 9.8	19216824760	74	522 54 12-01	BUSHING 19.05	19216334240
26	535 40 28-59	FILTER 105	168T2025220	75	535 41 46-16	BRAKE SHOE	1A646036121
27	535 40 28-63	BOLT 10 * 75	26106100752	76	535 40 28-38	BRAKE LEVER	1A646036160
31	535 40 28-64	CYLINDER BLOCK (PUMP) KIT	19216825111	77	535 41 46-17	BRAKE SHAFT	1A646036171
32	535 40 28-69	SPRING	1A646025200	78	535 40 28-39	BRAKE RETURN SPRING	168T2036180
33	505 56 45-01	PUMP SHAFT, STANDARD	1A646025251	79	535 41 46-18	BRAKE ACTUATOR	1A646036200
34	535 40 28-07	E-RING 15	19215485310	80	535 40 28-40	SPRING PIN 5 * 32	22351050032
35	535 40 28-71	BEARING 6202C3	24101062020	81	535 41 46-19	O-RING 1A P12	24311000120
36	535 40 28-72	MOTOR HOUSING	19216824210	82	535 40 28-41	SPRING PIN 4 * 16	22351040016
37	522 53 85-01	THRUST BEARING 51106	1A646034750	83	506 98 66-01	SPLINE COLLAR	1A646025300
38	535 40 28-74	CYLINDER BLOCK (MOTOR) KIT	187Q00025140	84	580 65 64-01	PULLEY L	1A646025810
39	535 40 28-79	WASHER 12 * 24 * 1	19216825230	85	506 98 68-01	FAN, BLACK	1A646083070
40	502 45 17-01	MOTOR SHAFT	1A646025271	86	506 98 65-01	WAVE WASHER	1A646083060
41	535 40 28-81	SNAP RING S15	19215425310	87	735 31 15-00	SNAP RING	19215489090
42	522 54 10-01	BRAKE DISC/MOTOR GEAR (10T)	1A646085250	90	535 40 28-16	SPRING PIN 3.0A * 20	22351030020
43	535 40 28-83	BEARING 6202 RSR C3	168T2025280	91	535 40 28-46	OIL SEAL 16 * 22 * .03	1A646024440
44	535 40 28-84	THRUST METAL	19216327051	95	535 40 28-33	SPRING PIN 3.0A * 16	22351030016
45	502 45 52-01	SWASH PLATE	168T2084700	96	505 56 50-01	ROLL PIN 3.5 * 40	22351035040
49	502 45 22-01	CONTROL SHAFT	1A646029911	99	Included # 200	SEALANT	1A646099500
50	502 45 23-01	FULCRUM	168T2029920	115	505 56 51-01	SWITCH 6440-11 DELTA	1A632086550
51	505 56 47-01	TORSION SPRING	168T2029800	116	505 56 52-01	SWITCH BRACKET	1A646083250
52	535 41 49-51	CONTROL ARM A	168T2029740	199	502 45 31-01	THRUST BEARING ASSEMBLY (PUMP)	1A646088150
53	505 56 48-01	CONTROL LEVER F	1A646029400	200	502 45 33-01	K46 & T40 SEAL KIT (ALL MODELS)	1A646099140
54	535 40 28-91	JERKY PLATE	168T2029350	201	522 54 13-01	REPAIR KIT K46	1A646099560
55	535 40 28-13	WASHER 12	22137120000				