

HAND PLANER

L-580A

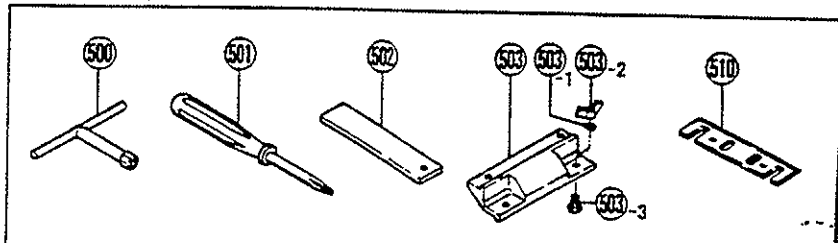
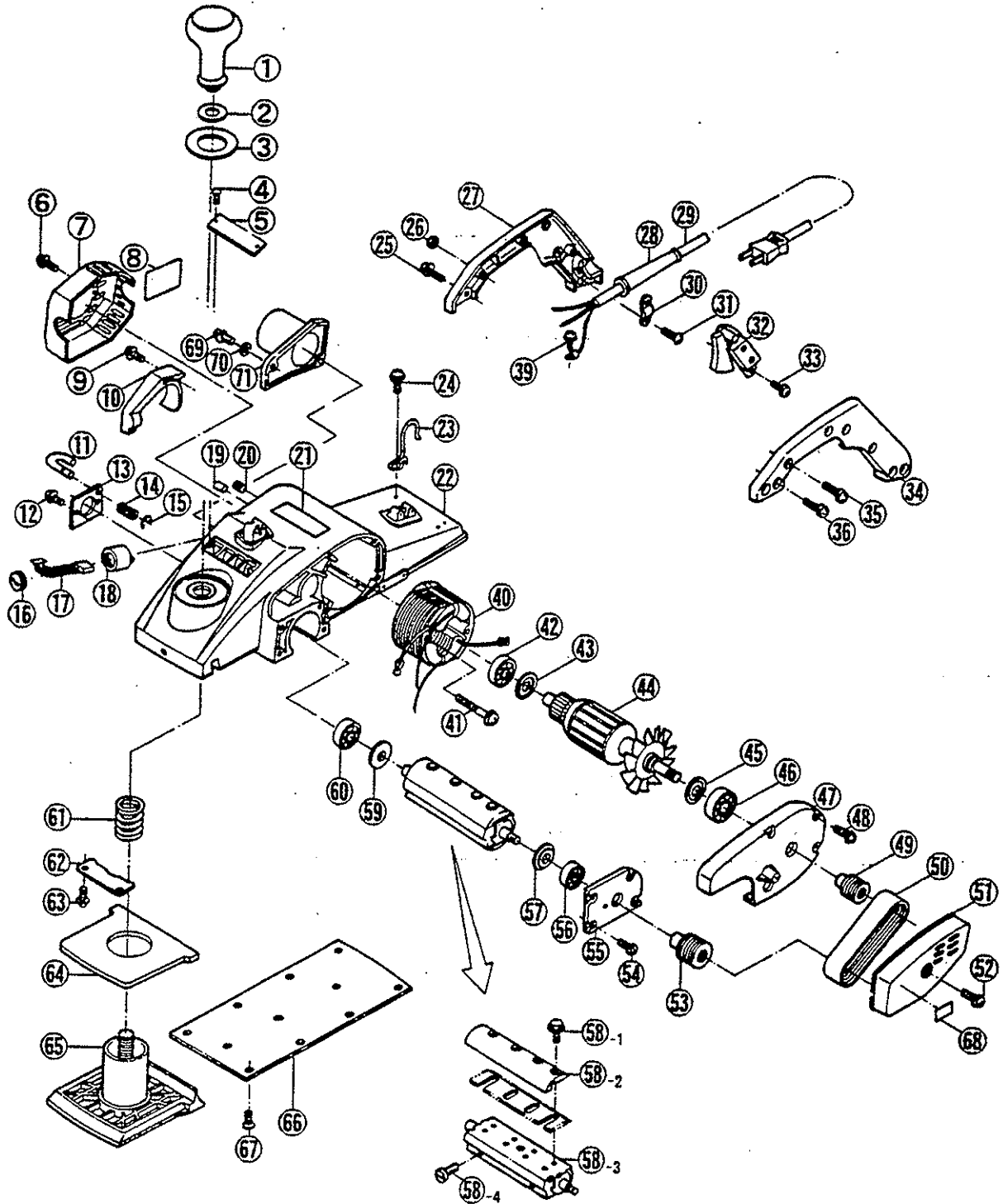

PARTS LIST FOR AFTER SALES SERVICE MODEL L580A

| # | PART NO. | DESCRIPTION | QTY | REF | PART NO. | DESCRIPTION | QTY | |
|----|-----------|--------------------------|-----|--|-----------|---------------------------|-----|--|
| 1 | 6830492 | KNOB | 1 | 52 | 9020512 | PHILLIPS PAN SCREW M5X25 | 4 | |
| 2 | 6900383 | WASHER | 1 | 53 | 6860045 | PULLEY (L) | 1 | |
| 3 | 6920252 | DEPTH SCALE "INCH" | 1 | 54 | 9020412 | PHILLIPS PAN SCREW M4X12 | 4 | |
| 4 | 6120005 | RIVET #2 | 2 | 55 | 6880350 | BLOCK COVER | 1 | |
| 5 | 6910847 | NAME PLATE | 1 | 56 | 9826201 | BALL BEARING #6201LLB | 1 | |
| 6 | 9040512 | TAPPING SCREW (S) M5X12 | 2 | 57 | 6150590 | CUST COLLAR | 1 | |
| 7 | 6800501 | TAIL COVER | 1 | 58 | 6940562 | CUTTER BLOCK COMPLETE | 1 | |
| 8 | 6920256 | WARNING LABEL | 1 | 58-1 | 6131157 | HEX HEAD BOLT M6X17 | 8 | |
| 9 | 9020430 | PHILLIPS PAN SCREW M4X30 | 4 | 58-2 | 6940182 | BLADE BINDER | 2 | |
| 10 | 6320079 | DUST COVER | 1 | 58-3 | 6940558 | CUTTER BLOCK | 1 | |
| 11 | 6120083 | LOCK PIN | 1 | 58-4 | 6130550 | ADJUSTMENT SCREW M5X17 | 4 | |
| 12 | 9020412 | PHILLIPS PAN SCREW M4X12 | 2 | 59 | 6150593 | DUST COLLAR | 1 | |
| 13 | 6150584 | BEARING COVER | 1 | 60 | 969235005 | BALL BEARING #6200LLB | 1 | |
| 14 | 6180084 | COMPRESSION SPRING | 1 | 61 | 6180074 | COMPRESSION SPRING | 1 | |
| 15 | 9500300 | RETAINING RING E-3 | 1 | 62 | 6150587 | GUIDE PLATE | 1 | |
| 16 | 6570033 | BRUSH CAP | 2 | 63 | 9040410 | TAPPING SCREW (S) M4X10 | 2 | |
| 17 | 6540373 | CARBON BRUSH SET | 1 | 64 | 6370061 | DUST SPONGE | 1 | |
| 18 | 6570032 | BRUSH HOLDER | 2 | 65 | 6850180 | FRONT SHOE | 1 | |
| 19 | 6120082 | RUBBER KNOCK | 2 | 66 | 6850181 | REAR SHOE | 1 | |
| 20 | 9280508 | CLAMP SCREW M5X8 | 2 | 67 | 9140410 | PHILLIPS FLAT SCREW M4X10 | 12 | |
| 21 | 6920258 | "RYOBI" MARK | 1 | — | 6560008 | TERMINAL | 3 | |
| 22 | 6800493 | FRAME | 1 | — | 6560002 | CONNECTOR | 1 | |
| 23 | 6180083 | CORD STAND | 1 | — | 6130910 | PHILLIPS PAN SCREW M4X8 | 2 | |
| 24 | 9020615 | PHILLIPS PAN SCREW M6X15 | 1 | STANDARD ACCESSORIES | | | | |
| 25 | 9000512 | PHILLIPS PAN SCREW M5X12 | 4 | 500 | 6240063 | BLADE WRENCH | 1 | |
| 26 | 9310400 | HEX NUT M4 | 3 | 501 | N/A | * SCREWDRIVER PHILLIPS | 1 | |
| 27 | 6830486 | HANDLE (A) | 1 | 502 | 6071923 | BLADE ADJUSTMENT GAUGE | 1 | |
| 28 | 6560047 | CORD HOLDER | 1 | 503 | 6070173 | SHARPENING HOLDER | 1 | |
| 29 | 6520233 | CORD ASS'Y AWG#16X3X2 | 1 | 503-1 | 6900101 | WASHER | 4 | |
| 30 | 6560055 | CORD CLAMP | 1 | 503-2 | 9340500 | WING NUT M5 | 4 | |
| 31 | 9060416 | TAPPING SCREW (B) M4X16 | 2 | 503-3 | 9230515 | ROUND HEAD BOLT M5X15 | 4 | |
| 32 | 6550110 | TRIGGER SWITCH | 1 | 510 | 6660353 | STEEL PLANER BLADE | 1 | |
| 33 | 9020406 | PHILLIPS PAN SCREW M4X6 | 2 | * STANDARD HARDWARE ITEM | | | | |
| 34 | 6830490 | HANDLE (B) | 1 | SERVICE NOTES: | | | | |
| 35 | 9000430 | PHILLIPS PAN SCREW M4X30 | 3 | <div style="text-align: right; margin-bottom: 20px;"> </div> | | | | |
| 36 | 9000512 | PHILLIPS PAN SCREW M5X12 | 4 | | | | | |
| 39 | 9040410 | TAPPING SCREW (S) M4X10 | 1 | | | | | |
| 40 | 6500496 | FIELD COIL | 1 | | | | | |
| 41 | 9020560 | PHILLIPS PAN SCREW M5X60 | 2 | | | | | |
| 42 | 969235005 | BALL BEARING #6200LLB | 1 | | | | | |
| 43 | 9791029 | DUST SEAL | 1 | | | | | |
| 44 | 6030533 | ARMATURE | 1 | | | | | |
| 45 | 9791231 | DUST SEAL | 1 | | | | | |
| 46 | 9826201 | BALL BEARING #6201LLB | 1 | | | | | |
| 47 | 6800498 | HOUSING COVER | 1 | | | | | |
| 48 | 9020525 | PHILLIPS PAN SCREW M5X25 | 4 | | | | | |
| 49 | 6860047 | PULLEY (S) | 1 | | | | | |
| 50 | 6860040 | POLY V-BELT | 1 | | | | | |
| 51 | 6880346 | BELT COVER | 1 | | | | | |