



OF150200A

KEY NO.	PART NUMBER	DESCRIPTION	QTY	KEY NO.	PART NUMBER	DESCRIPTION	QTY	KEY NO.	PART NUMBER	DESCRIPTION	QTY
1	661075001	Screw (M5 x 28 mm)	11	27	692043001	Washer (ID6.5 x OD13 x 1t).....	4	56	204340002	Manifold Knob Assembly (Incl. Key No. 57)	1
2	311836001	Air Filter Assembly	1	28	678238004	Cotter Pin	2				
3	730372043	Power Cord	1	29	678889003	Washer (ID13.5 x OD24 x 2.5t).....	2	57	941120097	Regulator Knob Label	1
4	637359001	Retaining Ring	1	30	308451062	Wheel Assembly.....	2	58	673415001	Flywheel	1
5	204337002	Rear Motor Housing Assembly (Incl. Key No. 55)	1	31	620599036	Axle	2	59	563814002	Belt	1
				32	637215001	Lock Plate	2	60	204336002	Cam Assembly	1
6	673455001	Screw (1/2 in. x 30 mm)	1	33	660169060	Screw (M6 x 14 mm)	9	61	660798010	Screw w/Washer (M4 x 18 mm) ...	4
7	204335002	Rod Plate Assembly	1	34	531380001	Clip	3	62	534121001	Basket	1
8	204338001	Valve Plate Assembly	1	35	306736013	Check Valve.....	1	63	673453001	Screw (M6 x 48 mm)	1
9	563815001	Piston Ring	1	36	290013102	Pressure Switch	1	64	760271020	On/Off Switch.....	1
10	642567001	Rod Plate.....	1	37	695368003	Hose Connector	1	65	670494002	Hex Nut (M6)	2
11	662027001	Screw (M5 x 18 mm)	1	38	563426004	Air Hose.....	1	66	563501006	Seal Ring	2
12	636688001	Cylinder	1	39	635294004	Hose Clamp	2	67	311835001	Tube Assembly	1
13	563919002	O-Ring.....	1	40	660798004	Screw w/Washer (M4 x 12 mm) ...	1	68	790002001	Cable Tie	1
14	563920002	O-Ring.....	1	41	306737013	Manifold Assembly.....	1	69	290061321	Connecting Wire.....	1
15	642568001	Cylinder Cover	1	42	311360001	Safety Valve.....	1	70	290061322	Ground Wire	1
16	204341002	Piston Rod, Cylinder, Valve Plate And Cover Assembly (Incl. Key Nos. 7-15).....	1	43	306739001	Quick Connector	1	71	204775001	Front Housing Assembly (Incl. Key Nos. 72-76).....	1
				44	306741004	Pressure Gauge (255 psi)	1	72	941120181	Control Panel Label.....	1
17	941120344	Drain Valve Label.....	1	45	306741002	Pressure Gauge (350 psi)	1	73	941120179	On/Off Label.....	1
18	941112056	Data Label	1	46	564075001	Rubber Sleeve.....	1	74	941112054	Performance Label (Left).....	1
19	941112053	Warning Label (Fr/Sp)	1	47	637194001	Control Panel (Tank)	1	75	941112055	Performance Label (Right).....	1
20	941488237	Hot Surface Label	1	48	637356001	Control Panel (Manifold).....	1	76	941112058	Quick Start Label	1
21	941114180	Ridgid Logo Label.....	1	49	696142001	Handle	1				
22	204774001	Tank Assembly (Incl. Key Nos. 17-21).....	1	50	660058007	Screw (M6 x 18 mm)	1				
				51	637214001	Fixed Plate (Bracket).....	1				
23	660058006	Screw (M6 x 35 mm)	4	52	563929001	Rubber Pad	3				
24	660154002	Screw (M6 x 16 mm)	6	53	206495002	Motor and Bracket Assembly	1				
25	564356001	Feet	2	54	673454002	Screw (1/2 in. x 114 mm)	1				
26	306735004	Drain Valve Assembly.....	1	55	941112052	Warning Label (English).....	1				

Not Shown:

995000450 Operator's Manual
3-9-18
(Rev:01)

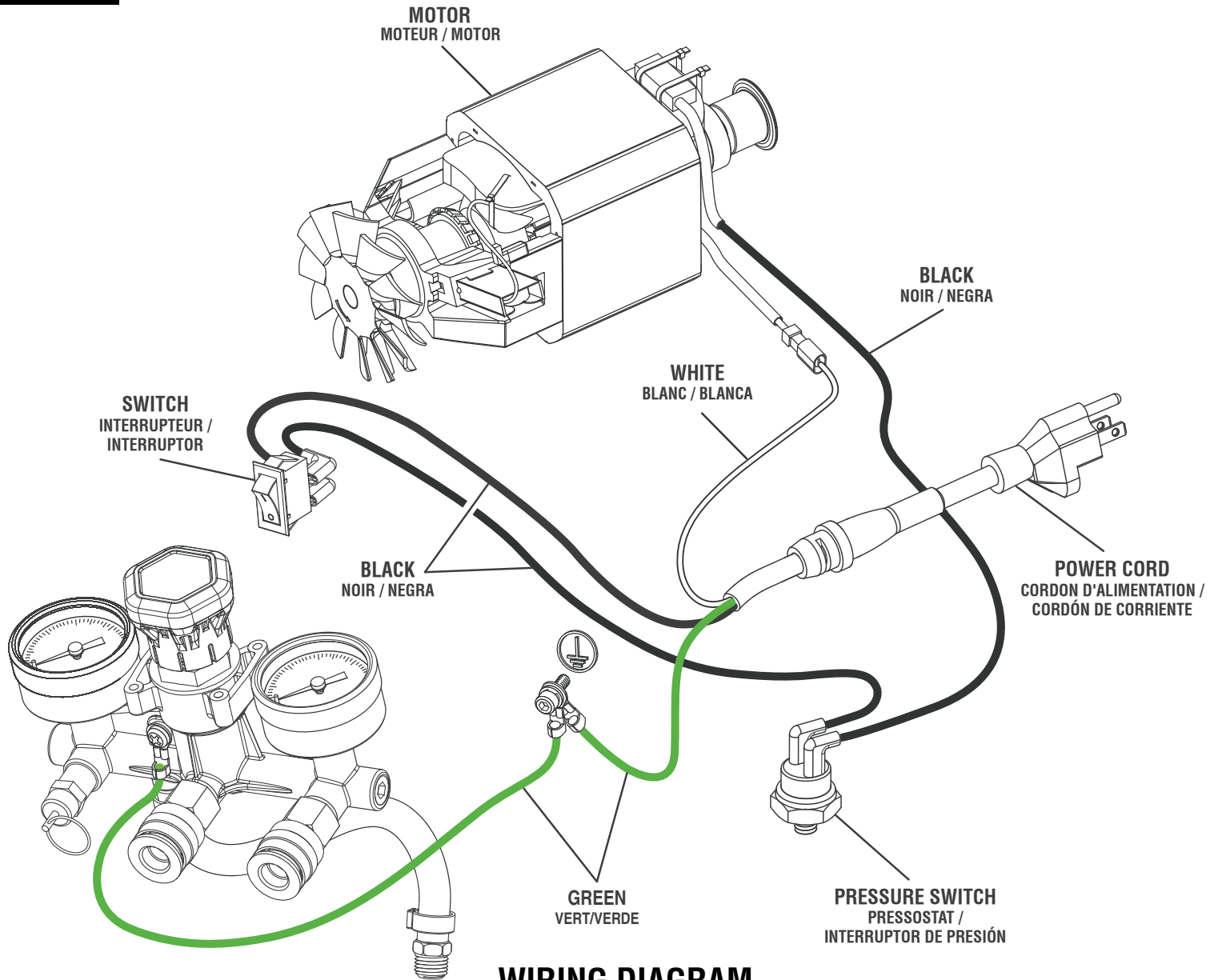

WIRING DIAGRAM
SCHÉMA DE CÂBLAGE /
DIAGRAMA DE CABLEADO