

ELECTRIC TOOL PARTS LIST

PLANER Model P 13F

2005 • 05 • 12
(E1)

SCHEMATIC A

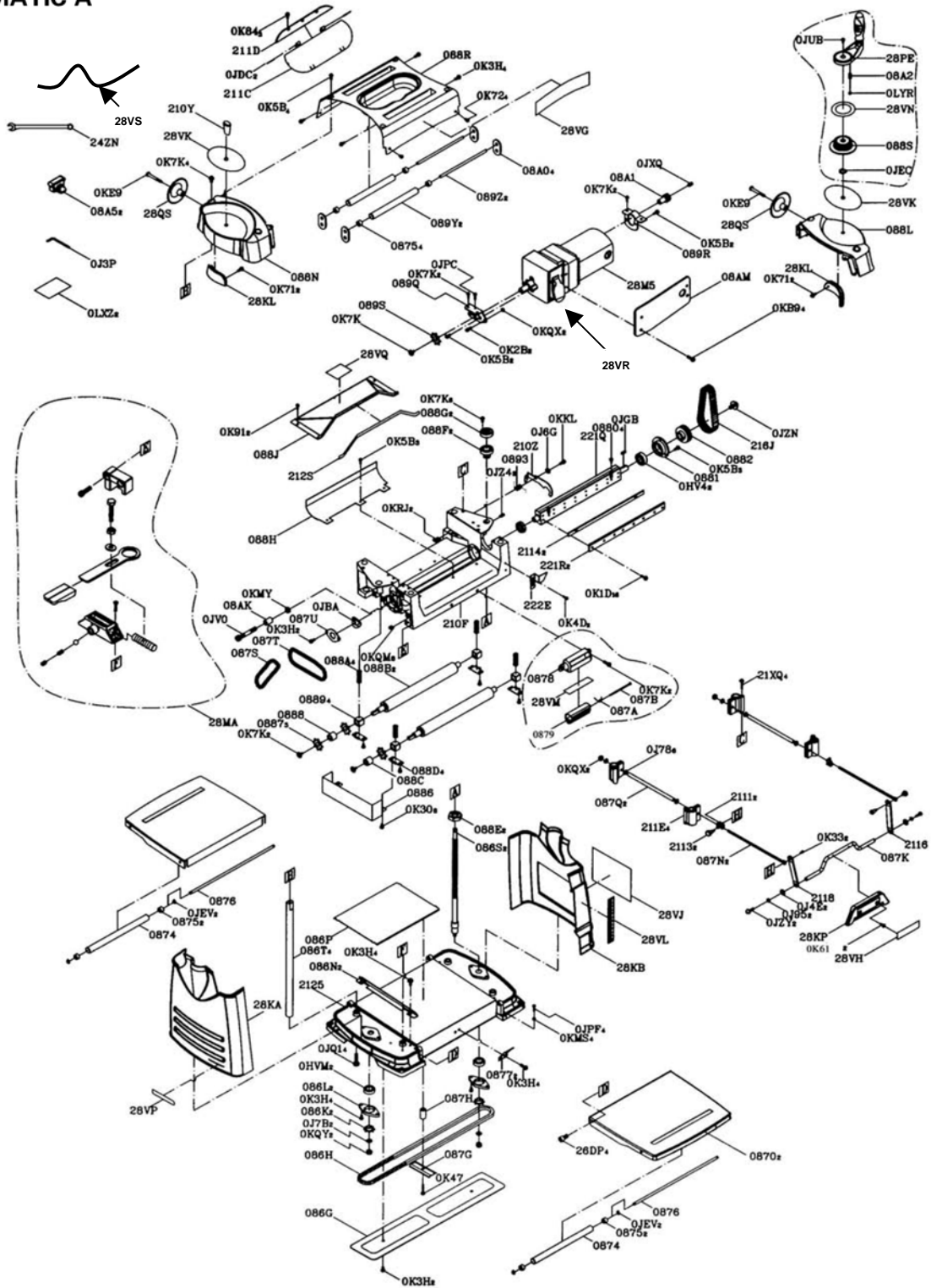

Parts List

Item #	Code #	DESCRIPTION OF SCHEMATIC "A"	NO USED	Remarks
2111	726339	CUSHION .	2	
2113	726340	SET BOLT M4X0.7-2B	2	
2114	726341	BLADE	2	
2116	726342	TENSION HANDLE	1	
2118	726343	TENSION HANDLE	1	
2125	726344	BASE	1	
086G	726390	INSERT	1	
086H	726391	CHAIN	1	
086K	726392	SPROCKET	2	
086L	726393	BEARING COVER	2	
086N	726394	GUIDE PLATE	2	
086P	726395	TABE PLATE	1	
086S	726396	SCREW BAR	2	
086T	726397	SUPPORT	4	
0870	726324	EXTENTION WING ASS'Y	2	
0874	726325	ROLLING WHEEL	2	
0875	726326	SHAFT SLEEVE	8	
0876	726327	SHAFT	2	
0877	726328	SPRING PLATE	2	
0878	726329	BODY	1	
0879	726330	NEEDLE POINTER	1	
087A	726398	SPRING	1	
087B	726399	RIVET	1	
087G	726400	ARM BRACKET	1	
087H	726401	SPACER	1	
087K	726402	HANDLE	1	
087N	726403	LINK BAR	2	
087Q	726404	SLEEVE	2	
087S	726405	CHAIN	1	
087T	726406	CHAIN	1	
087U	726407	BEARING COVER	1	
0880	726331	ADJUST SCREW	4	
0881	726332	BEARING SEAT	1	
0882	726333	PULLEY	1	
0886	726334	TABLE INSERT	1	
0887	726335	SPROCKET	3	
0888	726336	SHAFT SLEEVE	1	
0889	726337	ANCHOR BLOCK	4	
088A	726408	COMPRESSION SPRING	4	
088B	726409	FEED SHAFT	2	
088C	726410	SHAFT SLEEVE	1	
088D	726411	SET PLATE	4	
088E	726412	NUT	2	
088F	726413	NUT	2	
088G	726414	ADJUSTABLE NUT	2	
088H	726415	MITER GUIDE	1	
088J	726416	DUST PORT	1	
088L	726417	SIDE COVER	1	
088N	726418	SIDE COVER	1	
088R	726419	COVER	1	

Parts List

P13F

Item #	Code #	DESCRIPTION OF SCHEMATIC "A"	NO USED	Remarks
088S	726420	SCALE RING	1	
0893	726338	FOLLOWER PLATE	1	
089Q	726421	SET PLATE	1	
089R	726422	SET PLATE	1	
089S	726423	SPROCKET	1	
089Y	726424	ROLLING WHEEL	2	
089Z	726425	SHAFT	2	
08A0	726426	BRACKET TRAY	4	
08A1	726427	MOTOR PULLEY	1	
08A2	726428	SPRING	1	
08A5	726429	SETTING GAUGES	2	
08AK	726430	COLLAR	1	
08AM	726431	MOTOR BASE	1	
0HV4	726467	BALL BEARING	2	
0HVM	726468	BALL BEARING	2	
0J3P	726473	WRENCH HEX.	1	
0J4E	726477	FLAT WASHER ϕ 6*13-1	2	
0J6G	726484	FLAT WASHER ϕ 8.2*18-2.0	1	
0J78	726491	FLAT WASHER 1/4*1/2-3/32	6	
0J7B	726492	FLAT WASHER 5/16*25/32-1/8	2	
0J95	726497	SPRING WASHER ϕ 6	2	
0JBA	726504	WAVE WASHER BWW-6203	1	
0JDC	726511	SPRING PIN 2.5-22	2	
0JEC	726512	C-RING A-15	1	
0JEV	726514	E-RING E-6	4	
0JGB	726518	PARALLEL KEY 5*5-15	1	
0JPC	726524	HEX. HD. BOLT M6*1.0-12	1	
0JPF	726525	HEX. HD. BOLT M6*1.0-25	4	
0JQ1	726529	HEX. HD. BOLT M10*1.5-45	4	
0JUB	726530	HEX. SOC. HD. CAP BOLT M5*0.8-12	1	
0JV0	726531	HEX. SOC. HD. CAP BOLT M8*1.25-45	1	
0JXQ	726536	HEX. SOC. SET SCREW M 10*1.5-12	1	
0JZ4	726537	HEX. SOC. SET SCREW M6*1.0-8	2	
0JZN	726314	HEX WASHER HD BOLT M8*1.25-20	1	
0JZY	726313	HEX. SOC. TRUSS HD. SCREW M6*1.0-12	2	
0K1D	726312	HEX. HD. SCREW AND WASHER M6*1.0-16	16	
0K2B	726539	HEX.SOCKET HD.CAP SCREWS M 6*1.0-16	2	
0K30	726541	HEX. SOCKET TRUSS HEAD & WASHER ASSEMBLIED M6*1.0-16	8	
0K33	726542	CR.RE. PAN HD. SCREW & WASHER M4*0.7-8	2	
0K3H	726544	CR.RE. PAN HD. SCREW & WASHER M6*1.0-12	20	
0K47	726546	CR.RE. PAN HD. SCREW & WASHER M6*1.0-20	1	
0K4D	726547	CR.RE. PAN HD. SCREW & WASHER M6*1.0-12	2	
0K5B	726550	CR. RE. COUNT HD. SCREW M6*1.0-12	14	
0K61	726551	CR. RE. COUNT HD. SCREW M5*0.8-12	2	
0K71	726552	CR.-RE. TRUSS HD. SCREW M5*0.8-8	4	
0K72	726553	CR.-RE. TRUSS HD. SCREW M5X0.8-12	4	
0K7K	726557	CR. RE. ROUND WASHER HD. SCREW M6*1.0-12	19	
0K84	726560	CR. RE.COUNT HD. TAPPING SCREW M4*0.7-12	3	

Parts List

P13F

Item #	Code #	DESCRIPTION OF SCHEMATIC "A"	NO USED	Remarks
0K91	726563	CR. RE. TRUSS HD. TAPPING SCREW M4*16-12	2	
0KB9	726573	CR.RE. PAN HD. TAPPING SCREW M5X16-10	4	
0KE9	726584	CR. RE. PAN HD. SCREW M6*1.0-30	2	
0KKL	726593	CR.RE. PAN HD. ROUND NECK SCREW M6*1.0-16	1	
0KMS	726597	HEX. NUT M6*1.0 T=5	4	
0KMY	726603	HEX. NUT M8*1.25T=6.5	1	
0KQM	726613	SQUARE NUT M6*1.0 T=5	8	
0KQX	726616	NUT CHUCK M6*1.0 T=6	4	
0KQY	726617	NUT CHUCK M8*1.25 T=8	2	
0KRJ	726619	U-TYPE NUT M4*0.7	2	
0LXZ	726636	DSICCANT	2	
0LYR	726637	STEEL BALL	1	
210F	726658	MIDDLE BASE	1	
210Y	726659	COVER	1	
210Z	726660	FOLLOWER PLATE	1	
211C	726661	TOOL BOX COVER	1	
211D	726662	TOOL BOX COVER	1	
211E	726663	BASE	4	
212S	726664	SPONGE	1	
216J	726667	V-RIBBED BELT(POIYOURETHANE)	1	
21XQ	726669	CR. RE. ROUND WASHER HD. SCREW	4	
221Q	726670	CUTTER HEAD	1	
221R	726671	PRESSURE BAR	2	
222E	726672	NEEDLE POINTER	1	
24ZN	726734	HANDLE	1	
26DP	726747	SPECIAL BOLT	4	
28KA	726792	PLATE COVER	1	
28KB	726793	COVER-RIGHT	1	
28KL	726794	HANDLE	2	
28KP	726795	KNOB	1	
28M5	726800	MOTOR ASS'Y	1	
28MA	726801	SCALE PLATE ASS'Y	1	
28PE	726814	HANDLE BAR ASS'Y	1	
28QS	726817	POWER CORD CLAMP	2	
28VG	726822	TRADE-MARK LABEL	1	
28VH	726823	CAUTION LABEL	1	
28VJ	726824	WARNING LABEL	1	
28VK	726825	STICKER	2	
28VL	726826	SCALE	1	
28VM	726827	SCALE	1	
28VN	726828	BRACKET-TILT	1	
28VP	726829	SCALE	1	
28VQ	726830	WARNING LABEL	1	
28VR	726811	ROCKER SWITCH	1	
28VS	726295	CORD	1	

