

ROUTER

R-500

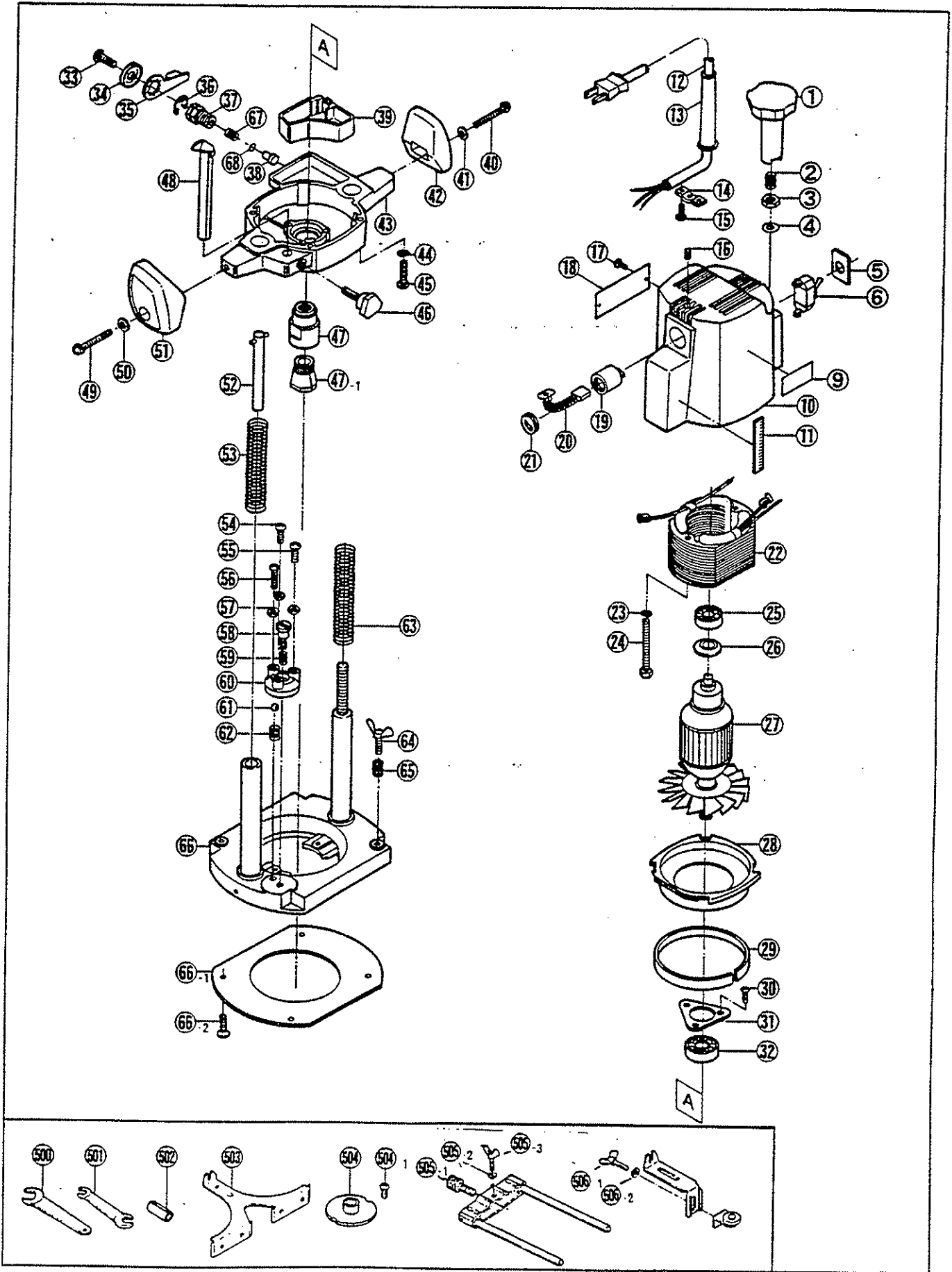

PARTS LIST FOR AFTER SALES SERVICE MODEL R500

	PART NO.	DESCRIPTION	QTY	REF	PART NO.	DESCRIPTION	QTY
	6832047	KNOB	1	46	6130282	KNOB BOLT M5X15	1
2	6180056	COMPRESSION SPRING	1	47	6940123	COLLET CHUCK	1
3	9331000	HEX NUT M10	1	47-1	6940118	COLLET SLEEVE	1
4	6900181	WASHER	1	48	6090075	STOP POLE	1
5	6920213	SWITCH PLATE	1	49	9020530	PHILLIPS PAN SCREW M5X30	1
6	6550016	TOGGLE SWITCH	1	50	9570500	WASHER	1
9	6921070	"RYOBI" MARK	1	51	6830332	HANDLE (L)	1
10	6801813	MOTOR HOUSING	1	52	6100058	AUX. GUIDE BAR	1
11	6920209	SCALE "INCH"	1	53	6180629	COMPRESSION SPRING	1
12	6520235	CORD ASS'Y AWG14X2X2	1	54	9000514	PHILLIPS PAN SCREW M5X14	1
13	6560044	CORD HOLDER	1	55	9000520	PHILLIPS PAN SCREW M5X20	1
14	6560057	CORD CLAMP	1	56	9000530	PHILLIPS PAN SCREW M5X30	1
15	9060414	TAPPING SCREW (B) M4X14	2	57	9310500	HEX NUT M5	3
16	9280505	CLAMP SCREW M5X5	2	58	6130276	CLAMP BOLT	1
17	6120009	RIVET #2	2	59	6180056	COMPRESSION SPRING	1
18	6910653	NAME PLATE	1	60	6320048	STOP BLOCK	1
19	6570019	BRUSH HOLDER	2	61	6290087	STEEL BALL 1/4"	1
20	6540213	CARBON BRUSH SET	1	62	6180055	COMPRESSION SPRING	1
21	6570005	BRUSH CAP	2	63	6180629	COMPRESSION SPRING	1
22	6500374	FIELD COIL	1	64	6130395	WING BOLT M6X15	2
23	9550500	SPRING WASHER M5	2	65	6180004	COMPRESSION SPRING	2
24	9060560	TAPPING SCREW (B) M5X60	2	66	6010051	BASE	1
25	969235005	BALL BEARING #6200LLB	1	66-1	6360054	BASE PLATE	1
	6900713	DUST COLLAR	1	66-2	9150410	FLAT TAPPING SCREW (S) M4X10	1
2.	6030392	ARMATURE	1	67	6180485	TORSION SPRING	1
28	6490076	COVER	1	68	9760010	O-RING P-10	1
29	6490081	FAN CASING	1	---	6560003	CONNECTOR	1
30	9040410	TAPPING SCREW (S) M4X10	3	---	9674316	LEAD WIRE	1
31	6150446	CLAMP PLATE	1	X	X	STANDARD ACCESSORIES	X
32	9826201	BALL BEARING #6201LLB	1	500	6240263	SINGLE-END WRENCH	1
33	9020610	PHILLIPS PAN SCREW M6X10	1	501	6241073	OPEN-END WRENCH	1
34	6900167	WASHER	1	502	6072223	1/4" X 1/2" BIT ADAPTER	1
35	6830339	CLAMP LEVER	1	---	6072213	3/8" X 1/2" BIT ADAPTER	1
36	9501000	RETAINING RING E-10	1	503	6150453	STRAIGHT GUIDE	1
37	6130281	CLAMP SCREW	1	504	6072313	TEMPLATE GUIDE	1
38	6120072	DRIVE PIN	1	504-1	9120508	TRUSS HEAD SCREW M5X8	2
39	6590124	INSULATION COVER	1	505	6070573	GUIDE HOLDER	1
40	9020530	PHILLIPS PAN SCREW M5X30	1	505-1	6130278	ADJUSTMENT SCREW	1
41	9570500	WASHER	1	505-2	9570600	WASHER	1
42	6830329	HANDLE (R)	1	505-3	9240610	WING BOLT M6X10	1
43	6320046	BRACKET	1	506	6070563	TRIMMER GUIDE	1
44	9550500	SPRING WASHER M5	4	506-1	9240610	WING BOLT M6X10	1
45	9060550	TAPPING SCREW (B) M5X50	4	506-2	9570600	WASHER	1

SERVICE NOTES: