

TRIMMER

TR-30U

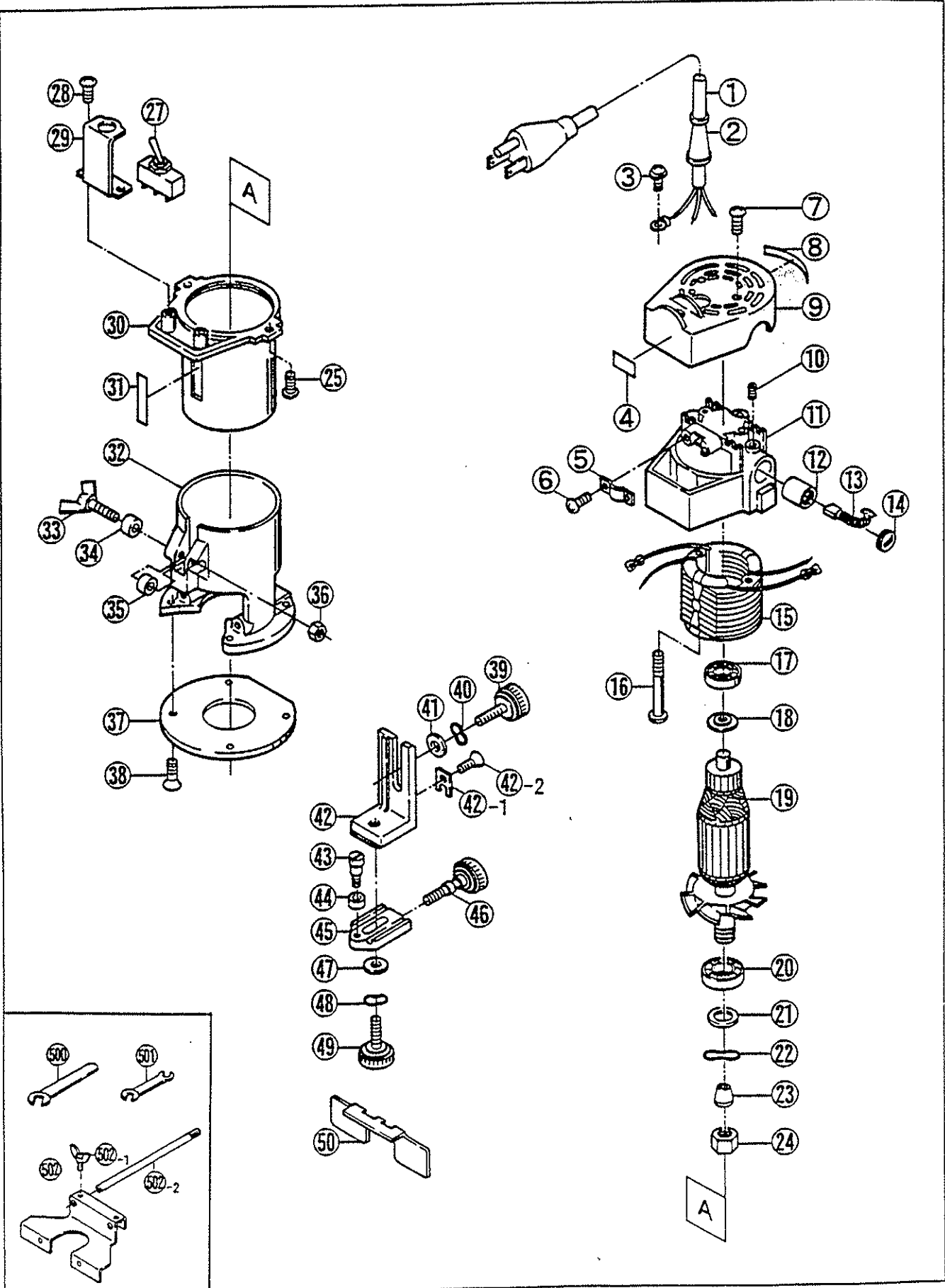

**PARTS LIST FOR AFTER SALES SERVICE
MODEL TR-30U**

REF	PART NO.	DESCRIPTION	QTY	REF	PART NO.	DESCRIPTION	QTY
1	6520232	CORD ASS'Y AWG#18X3X2	1	32	6850143	BASE	1
2	6560131	CORD HOLDER	1	33	9240635	WING BOLT M6X35	1
	9020412	PHILLIPS PAN SCREW M4X12	1	34	6900198	COLLAR	1
4	6920222	"RYOBI" MARK	1	35	6900198	COLLAR	1
5	6560055	CORD CLAMP	1	36	9300600	HEX NUT M6	1
6	9040414	TAPPING SCREW (S) M4X14	2	37	6360072	BASE PLATE	1
7	9040412	TAPPING SCREW (S) M4X12	2	38	9140410	PHILLIPS FLAT SCREW M4X10	4
8	6910724	NAME PLATE	1	39	6830392	KNOB BOLT	1
9	6800404	TAIL COVER	1	40	6900697	WAVE WASHER	1
10	9280506	CLAMP SCREW M5X6	2	41	9560600	WASHER	1
11	6320075	BRACKET	1	42	6080423	GUIDE HOLDER	1
12	6570002	BRUSH HOLDER	2	42-1	6150483	GUIDE PLATE	1
13	6540033	CARBON BRUSH SET	1	42-2	9150410	FLAT TAPPING SCREW (S) M4X10	1
14	6570070	BRUSH CAP	2	43	6130300	FLAT HEAD SCREW	1
15	6500429	FIELD COIL	1	44	6860357	ROLLER	1
16	9020455	PHILLIPS PAN SCREW M4X55	2	45	6330010	TRIMMER GUIDE	1
17	9840627	BALL BEARING #627LLB	1	46	6830387	KNOB BOLT	1
18	6150564	BEARING COLLAR	1	47	9560600	WASHER	1
19	6030456	ARMATURE	1	48	6900697	WAVE WASHER	1
20	9846002	BALL BEARING #6002LLB	1	---	6560002	CONNECTOR	1
21	6900670	THRUST WASHER	1	---	6560008	TERMINAL	1
22	9643200	WAVE WASHER	1	---	6560020	TERMINAL	2
23	6940139	COLLET SLEEVE 1/4"	1	49	6830392	KNOB SCREW	
24	6130302	COLLET NUT	1	50	6320073	CLEAR DUST COVER GUARD	
25	9040412	TAPPING SCREW (S) M4X12	2			STANDARD ACCESSORIES	
	6550016	TOGGLE SWITCH	1	500	6240533	SINGLE-END WRENCH 17	1
28	9040412	TAPPING SCREW (S) M4X12	2	501	6240623	OPEN-END WRENCH	1
29	6590132	BRACKET	1	502	6072063	STRAIGHT GUIDE	1
30	6800399	MOTOR HOUSING	1	502-1	9240412	WING BOLT M4X12	2
31	6920223	SCALE	2	502-2	6960037	GUIDE BAR	2

SERVICE NOTES:

* CLEAR PLATE #6360072